

Double-Take[®] 7.0



**ANYTHING TO ANYWHERE,
RISK-FREE, NEAR-ZERO
DOWNTIME MIGRATIONS
TO THE CLOUD OR NEW
PHYSICAL AND VIRTUAL
SERVERS**

Double-Take[®] Move[™] 7.0

Businesses that want to trim computing costs and improve efficiency are looking to the benefits of virtualization and cloud computing for their server workloads. These benefits include simplified deployment and management in addition to lower cost of ownership for infrastructure. Businesses that are moving to these computing platforms need migration tools and processes that are as simple and efficient as the platforms they are moving to.

What's the best way to migrate your core production server, application, and data workloads?

Migrations Made Easy

Double-Take Move 7.0 allows you to migrate physical, virtual, and cloud based Windows server workloads with real-time replication from a single, intuitive user console. Protect your productivity with technology that eliminates user and application downtime during migrations. Double-Take Move 7.0 migrates your entire

server including the system state, applications, file system, permissions, attributes, compression and encryption settings without suspending production operations. All system and application data is moved while it is live and online and Double-Take Move 7.0 ensures the write order integrity for all migrated data.

Anything to Anything Migrations

- Migrates between any combination of physical, virtual, and cloud platforms
- Hardware independence between server and storage hardware
- Hypervisor independence between different virtual and cloud platforms
- Automatically provisions new virtual machines on Hyper-V and vSphere - no manual configuration required

Double-Take[®]
by Vision Solutions[®]

GO AHEAD. NO WORRIES.

Seamless Virtualization. Risk-Free Migration. Cloud Domination.

Near-Zero Downtime Migrations

- Captures all changes that users make during the migration and replicates them to the new server in real-time
- Migrates the entire system or just file or application data for standard or custom file and application servers and even domain controllers
- Continues replicating changes after the initial synchronization until the desired cutover time
- Migrations can be performed during business hours or at any time that makes sense for your business

Efficient Consolidation

- WAN-efficient, real-time data replication
- Flexible Bandwidth Limiting and Intelligent Compression features allow you to control how much bandwidth migration operations can consume
- Large data set migrations over a WAN can be pre-seeded to the target offline and Double-Take Move 7.0 will reconcile the differences

How It Works

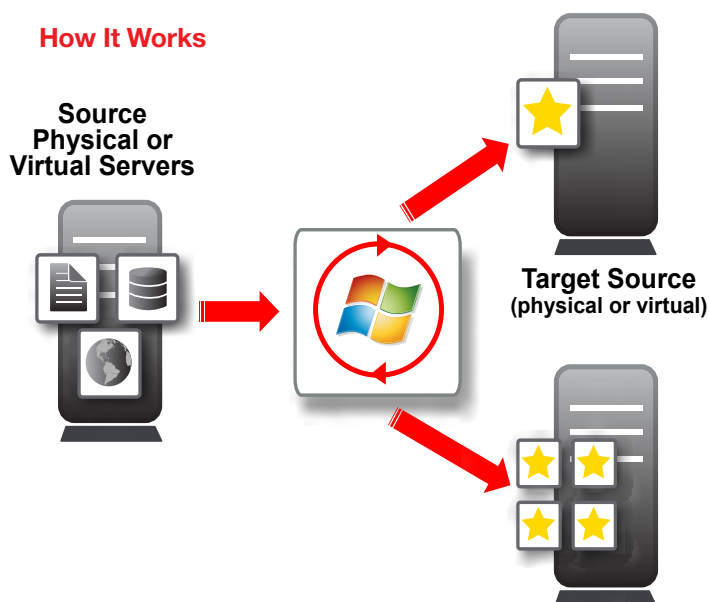

Simple, Flexible Configuration

- Continuously captures byte-level changes to a server's OS, applications and data
- Replicates changes to new physical or virtual hardware at any location, locally or globally
- Updates DNS for migrations across network subnets to help users easily reconnect after cutover, even across a WAN
- Migrates shared folders between servers, even if not migrating the system state to keep users connected to the data after the migration cutover
- Migrate to physical or virtual servers that have a different number of drives, drive sizes, CPUs or memory than the original source
- A simple interface lets you efficiently manage large migration projects
- Easy push-install and license management reduces deployment efforts
- Cutover to the new server can be executed manually or set up to be fully automatic
- For virtual server migrations, take advantage of the Test Cutover capabilities to proactively validate your migration cutover will work as planned

Operating Systems Supported

- Windows Server 2003 and 2003 R2
- Windows Server 2008 and 2008 R2
- Windows Server 2012
- Windows Small Business Server 2003 and 2011

Microsoft Partner

Gold Application Development
Gold Management and Virtualization
Gold Server Platform



For more information: 1 (800) 957-4511 • info@visionsolutions.com • visionsolutions.com